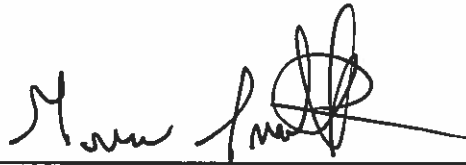

ORDINANCE NO. 18-2398

**AN ORDINANCE TO AMEND
ORDINANCE NO. 18-2383**

BE IT HEREBY ORDAINED by the City Council of the City of Hoover, Alabama, in regular meeting duly assembled, a quorum being present that Ordinance No. 18-2383, adopted by the City Council on June 18, 2018, is hereby amended by replacing the Exhibit "A" to the ordinance with the new attached Exhibit "A" in order to correct the legal description for property located at 118 Mars Hill Road.

ADOPTED this 6th day of August, 2018.

A handwritten signature in black ink, appearing to read "Gene Smith", written over a horizontal line.

Gene Smith, City Council President

APPROVED:

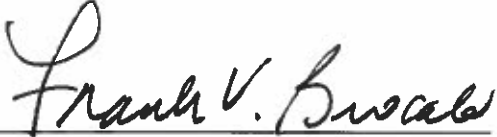
A handwritten signature in black ink, appearing to read "Frank V. Brocato", written over a horizontal line.

Mayor Frank V. Brocato

ATTESTED:

A handwritten signature in black ink, appearing to read "Margie Handley", written over a horizontal line.

Margie Handley, City Clerk

EXHIBIT "A"

Legal Description of Property – 118 Mars Hill Road

Begin at the Northeast corner of the Northwest Quarter of the Southwest Quarter of Section 27, Township 19 South, Range 3 West; thence run in a westerly direction along the north line of the northwest quarter of the southwest quarter for a distance of 329.11 feet to a point on the northeast right-of-way of Mars Hill Road; thence turn an angle to the left of 147 degrees 27 minutes 34 seconds to the tangent of a curve to the left having a central angle of 12 degrees 29 minutes 24 seconds and a radius of 1040.75 feet; thence run along the arc of said curve in a southeasterly direction along the northeast right-of-way for a distance of 226.88 feet to the end of said curve and the beginning of a curve to the left having a central angle of 2 degrees 20 minutes 33 seconds and a radius of 3347.00 feet; thence run along the arc of said curve in a southeasterly direction along the northeast right-of-way for a distance of 136.85 feet to a point on the east line of the northwest quarter of the southwest quarter; thence turn an angle from the tangent if extended to said curve to the left of 109 degrees 02 minutes 25 seconds and run in a northerly direction along the east line of the northwest quarter of the southwest quarter for a distance of 144.62 feet to the point of beginning. Situated in Jefferson County, Alabama.

118 Mars Hill Rd

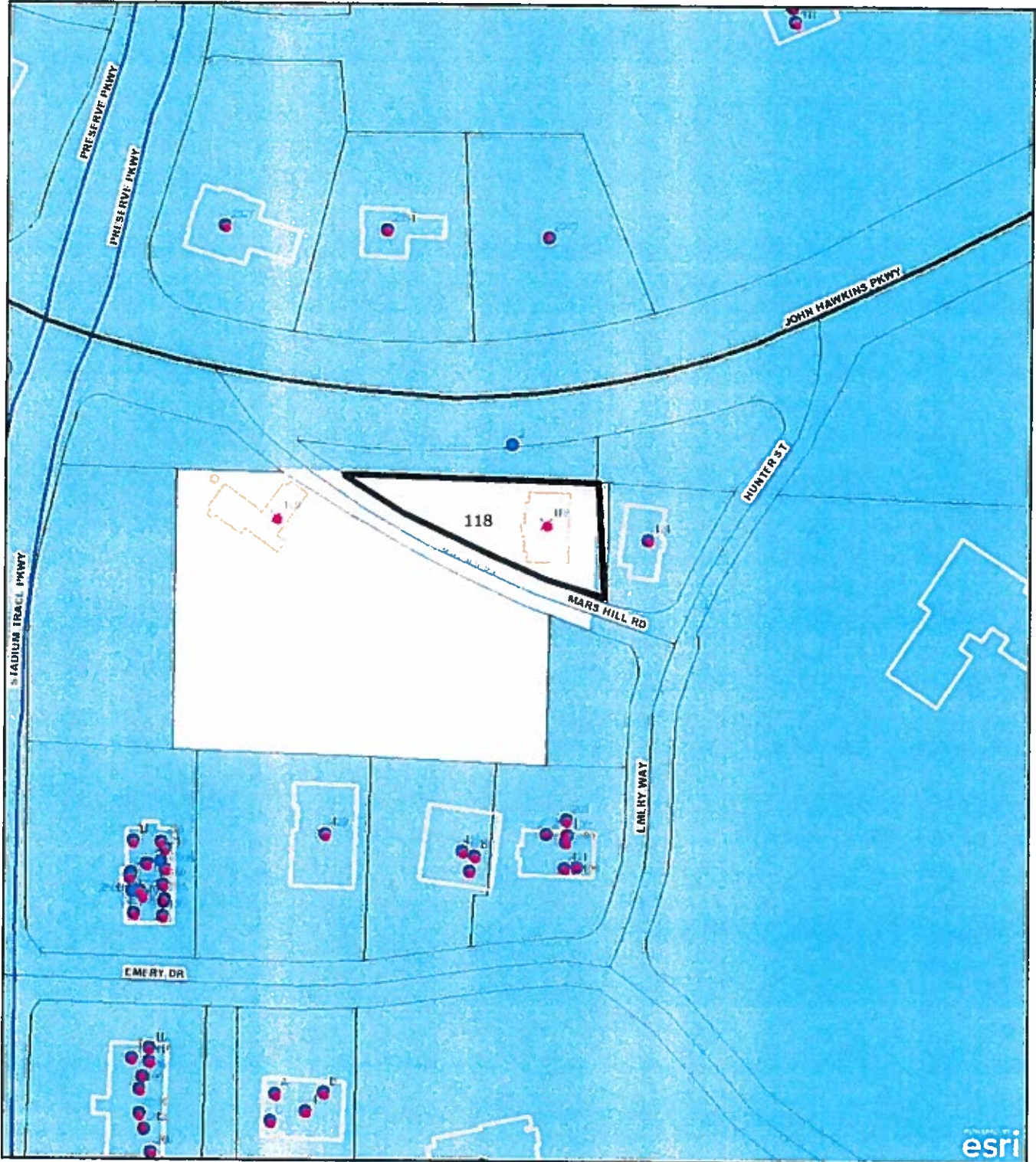

esri

209 ft
Scale Per Inch



This City of Hoover Geographic Information System (GIS) map is used for reference purposes only. The City of Hoover does not guarantee accuracy of the material contained herein and is not responsible for misuse or

Powered by
VANTAGEPOINTS

ORDINANCE NO. 18-2383

An ordinance to alter, rearrange and extend the corporate limits of the City of Hoover, Alabama, so as to embrace and include within the corporate limits of said City all territory now within such corporate limits and also certain other territory contiguous to said City.

WHEREAS, a petition signed by Spine & Sports Properties, LLC requesting that certain territory described therein be annexed to the City of Hoover, and

WHEREAS, there is attached to the said petition a map of said territory showing its relationship to the corporate limits of the City; and

WHEREAS, this Council has determined and found that the matters set forth and alleged in the said petition are true and that it is in the public interest that said property be annexed into the City of Hoover;

NOW, THEREFORE, be it ordained by the Council of the City of Hoover as follows:

SECTION 1: That said Council hereby assents to the annexation of said territory to the City of Hoover, Alabama, and the corporate limits of the City of Hoover are hereby extended and rearranged pursuant to the provisions of Chapter 42, Article 2, Code of Alabama, 1975 (Sections 11-42-20 through 11-42-23, as amended) so as to embrace and include said territory, in addition to the territory already within its present corporate limits, within the corporate area of said City, which said territory is not within the corporate limits or municipal boundaries of another municipality and does not lie at any point more than one-half the distance between the present corporate limits or municipal boundaries of another municipality and does not lie at any point more than one-half the distance between the present corporate limits and the corporate limits of any other municipality. Said property is described in **Exhibit "A"** attached hereto and made a part hereof.

SECTION 2: The City Clerk shall file a certified copy of this ordinance containing an accurate description of said annexed territory with the Probate Judge of Jefferson County, Alabama, and publish a copy of this ordinance as required by state law.

ADOPTED this the 18th day of June, 2018.



Gene Smith, City Council President

APPROVED BY:



Mayor Frank V. Brocato

ATTESTED:



City Clerk Margie Handley

Parcel I:

A PARCEL OF LAND LOCATED IN THE SOUTHWEST 1/4 OF THE NORTHWEST 1/4 OF SAID SECTION 27, TOWNSHIP 19 SOUTH, RANGE 3 WEST BEING MORE PARTICULARLY DESCRIBE AS FOLLOWS:

BEGIN AT THE SOUTHEAST CORNER OF SAID 1/4 - 1/4 SECTION AND RUN NORTH ALONG THE EAST LINE OF SAID 1/4 - 1/4 A DISTANCE OF 68.51 FEET TO THE SOUTH BOUNDARY OF STATE OF ALABAMA HIGHWAY # 150 AND ALSO THE BEGINNING OF A NON-TANGENT CURVE TO RIGHT WITH A RADIUS OF 1285.10 FEET, A CENTRAL ANGLE OF 18°34'22" AND A CHORD OF 414.75 FEET; THENCE LEFT IN A WESTERLY DIRECTION ALONG THE SOUTH BOUNDARY OF SAID HIGHWAY AND ALONG THE ARC OF SAID CURVE A DISTANCE OF 416.57 FEET TO THE INTERSECTION WITH THE EAST BOUNDARY OF MARS HILL ROAD; THENCE TURN TO THE LEFT A SOUTHEASTERLY DIRECTION ALONG THE NORTH BOUNDARY OF SAID MARS HILL ROAD A DISTANCE OF 99.02 FEET TO THE SOUTH LINE OF SAID SOUTHWEST 1/4 OF THE NORTHWEST 1/4; THENCE TURN AN ANGLE TO THE LEFT IN A EASTERLY DIRECTION ALONG THE SOUTH LINE OF SAID 1/4 - 1/4 A DISTANCE OF 329.09 FEET TO THE POINT OF BEGINNING.

118 Mars Hill Rd

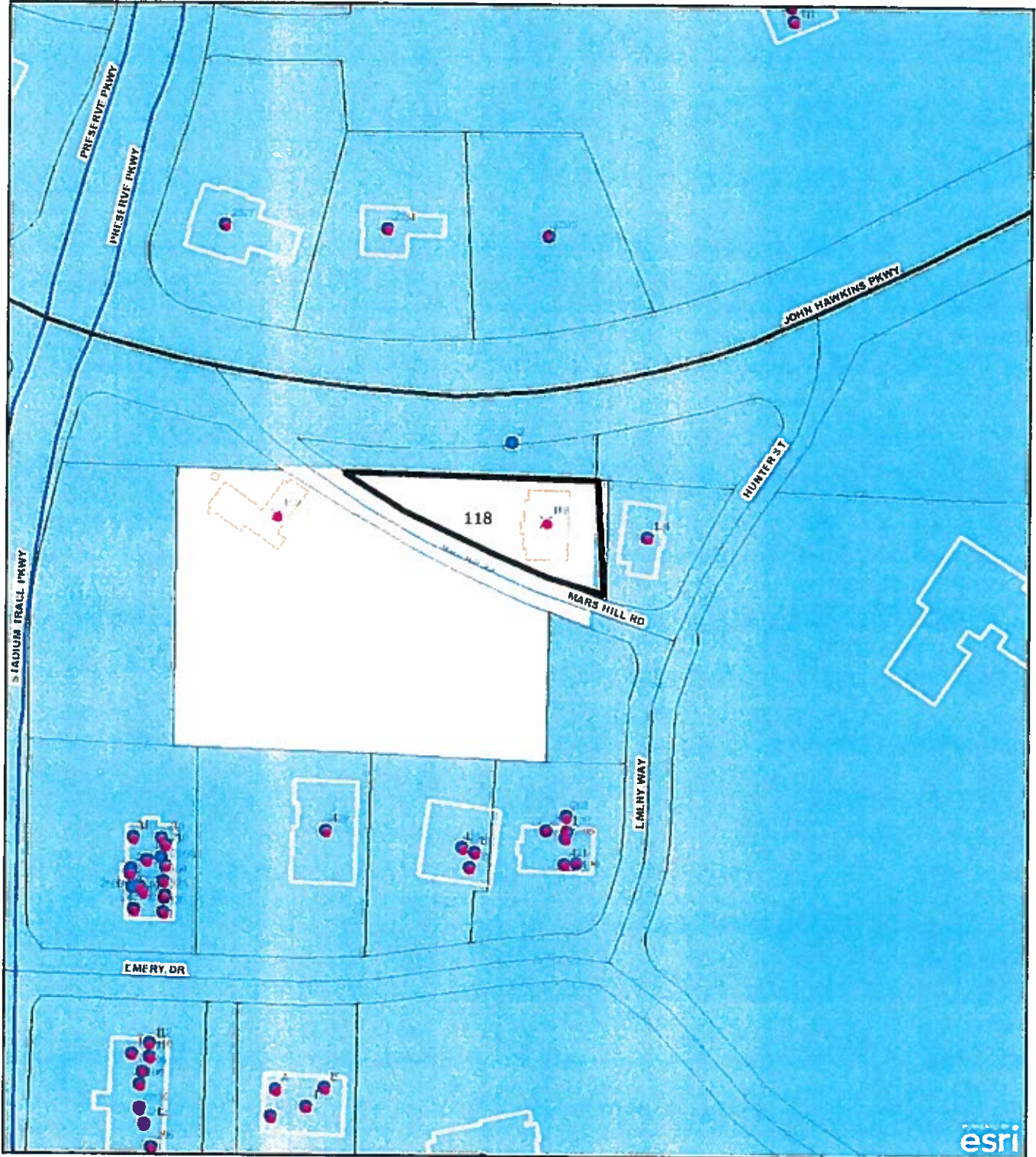

209 ft
Scale Per Inch



This City of Hoover Geographic Information System (GIS) map is used for reference purposes only. The City of Hoover does not guarantee accuracy of the material contained herein and is not responsible for misuse or

Powered by
VANTAGEPOINTS