

ORDINANCE NO. 18-2396

**AN ORDINANCE TO AMEND ORDINANCE NO. 263
OF THE CITY OF HOOVER, ALABAMA, ENTITLED
"THE ZONING ORDINANCE OF THE CITY OF HOOVER, ALABAMA".**

**BE IT ORDAINED BY THE COUNCIL OF THE CITY OF HOOVER, ALABAMA, AS
FOLLOWS:**

SECTION 1. That the Zoning Map of the City of Hoover, Alabama, adopted as part of the Zoning Ordinance of the City of Hoover, Alabama, as heretofore amended, be and the same is amended as follows:

"That the property described on Exhibit "A" attached hereto and made a part hereof, now located in the City of Hoover, Alabama, be and from and after the enactment hereof, zoned **A -1 Agriculture District**, and the uses and restrictions applicable to **A-1 Agriculture District** as set out in the Zoning Ordinance of said City, as amended, shall govern and control the uses made of and permitted in said property."

SECTION 2. That all ordinances or parts of ordinances contrary to the provisions hereof are hereby repealed.

SECTION 3. That if any part, provision or section of this ordinance is declared to be unconstitutional, or invalid by any court of competent jurisdiction, such holdings shall not affect any other part, provision or section of this ordinance not thereby affected.

SECTION 4. That this ordinance shall become effective immediately upon its passage and approval by the Council and the Mayor of the City of Hoover, Alabama and publication as required by law.

ADOPTED this the 6th day of August 2018.



Mr. Gene Smith, President of the Council

APPROVED:



Mayor Frank V. Brocato

ATTESTED BY:



City Clerk Margie Handley

EXHIBIT "A"

Parcel I.D. #39-08-2-002-005.000 (1516 Melton Road)

Part of the North quarter of the Southwest quarter of Northwest quarter of Section 8, Township 19 South, Range 3 West, more particularly described as follows: Commence at the Northwest corner of the said North quarter of the Southwest quarter-Northwest quarter, Section 8, Township 19 South, Range 3 West, situated in Jefferson County, Alabama and run East along the North line of said quarter-quarter for 553.13 feet to the point of beginning; thence continue along the last named course for 132.22 feet; thence 88 degrees 03 minutes 40 seconds right for 329.44 feet; thence 91 degrees 56 minutes 20 seconds right for 132.22 feet; thence 88 degrees 03 minutes 40 seconds right for 329.44 feet to the point of beginning.

Parcel I.D. #39-08-2-002-005.001 (1518 Melton Road)

Part of the North quarter of the Southwest quarter of Northwest quarter of Section 8, Township 19 South, Range 3 West, more particularly described as follows: Commence at the Northwest corner of the said North quarter of the Southwest quarter-Northwest quarter, Section 8, Township 19 South, Range 3 West, situated in Jefferson County, Alabama and run East along the North line of said quarter-quarter for 685.35 feet to the point of beginning; thence continue along the last named course for 132.22 feet; thence 88 degrees 03 minutes 40 seconds right for 329.44 feet; thence 91 degrees 56 minutes 20 seconds right for 132.22 feet; thence 88 degrees 03 minutes 40 seconds right for 329.44 feet to the point of beginning.

Parcel I.D. #39-08-2-002-006.000 (1512 Melton Road)

Commence at the Northwest corner of the SW $\frac{1}{4}$ of NW $\frac{1}{4}$ of Section 8, Township 19 South, Range 3 West, and run East along the North line of said $\frac{1}{4}$ - $\frac{1}{4}$ for 420.91 feet to the point of beginning; thence continue along the last named course for 132.22 feet; thence 88 degrees 03 minutes 40 seconds right for 329.44 feet thence 91 degrees 56 minutes 20 seconds right for 132.22 feet; thence 88 degrees 03 minutes 40 seconds for 329.44 feet to the point of beginning.

Parcel I.D. #39-08-2-002-003.000 (1536 Melton Road)

Part of the North one-half of the Southwest Quarter of Northwest Quarter of Section 8, Township 19 South, Range 3 West more particularly described as follows: Commence at the Northwest corner of North one-half of Southwest Quarter of Northwest quarter of said Section 8, Township 19 South, Range 3 West and run East along North line of Southwest Quarter of Northwest quarter a distance of 949.79 feet to the Northeast corner of property conveyed in Real Volume 191, Page 197 to Robert Stagner and Frances Stagner which is the point of beginning, thence continue along the last named course for 132.22 feet to West line of property conveyed in Real Volume 182, Page 279, to Michael Cater and Judy Cater thence 88 degrees 03 minutes 40 seconds right and along West line of said Cater property a distance of 329.45 feet, to North line of property conveyed to William L. Chambers and Wilma M. Chambers in real Volume 157, Page 136, thence 91 degrees 56 minutes 20 seconds right and along North line of said Chambers property a distance of 132.22 feet to East line of property conveyed in Real Volume 191, Page 197, to Robert Stagner and Frances Stagner thence North along East line of said Stagner property a distance of 329.45 feet to point of beginning.

Parcel I.D. #39-08-2-002-002.000 (1542 Melton Road)

Part of the North half of the Southwest Quarter of the Northwest Quarter of Section 8, Township 19 South, Range 3 West, and more particularly described as follows: Commence at the Northeast corner of the above described Southwest Quarter of the Northwest Quarter for the Point of Beginning of the tract to be herein described; thence in a Westerly direction along the North line of said Quarter-Quarter run a distance of 209.00 feet; thence turn an angle of 92 degrees 02 minutes 51 seconds to the left and Southerly parallel with the East line of said Quarter-Quarter for 209.00 feet; thence turn an angle of 87 degrees 57 minutes 09 seconds to the left and Easterly parallel with the North line of said Quarter-Quarter for 209.0 feet to the East line of said Quarter-Quarter; thence turn an angle of 92 degrees 02 minutes 51 seconds to the left and along the East line of said Quarter-Quarter for 209.0 feet to the Point of Beginning, being situated in Jefferson County, Alabama.

Parcel I.D. #39-08-2-002-007.000 (2173 Silver Spur Lane)

Commence at the Northwest corner of the SW $\frac{1}{4}$ of the NW $\frac{1}{4}$ of Section 8, Township 19 South, Range 3 West, and run east along the North line of said $\frac{1}{4}$ - $\frac{1}{4}$ for 24.21 feet to the Point of Beginning; thence continue along the last named course for 396.70 feet; thence 88 degrees 03 minutes 40 seconds right for 329.44 feet; thence 91 degrees 56 minutes 20 seconds right for 396.70 feet; thence 88 degrees 03 minutes 40 seconds right for 329.44 feet to the Point of Beginning, situated in Jefferson County, Alabama.

Parcel I.D. #39-08-2-002-008.000 (2151 Silver Spur Lane)

Lot 1 Silver Spur Estates 1st Addition as recorded in MB 29/PG 92 in the office of the Judge of Probate, Jefferson County, Alabama, Bessemer Division.

Parcel I.D. #39-08-2-002-008.002 (2155 Silver Spur Lane)

Commence at the Northwest corner of the South $\frac{1}{2}$ of the North $\frac{1}{2}$ of the Southwest $\frac{1}{4}$ of the Northwest $\frac{1}{4}$ of Section 8, Township 19 South, Range 3 West; thence proceed in an Easterly direction along the North line of Said $\frac{1}{2}$ of the North $\frac{1}{2}$ of the Southwest $\frac{1}{4}$ of the Northwest $\frac{1}{4}$ of Section 8, Township 19 South, Range 3 West for a distance of 183.10 feet to the Northeast corner of Lot 1, Silver Spur Estates, First Addition (Map Book 29, Page 92 Bessemer Division) said point being the Point of Beginning; thence continue along the last described course for a distance of 311.77 feet; thence turn an angle to the right of 88 degrees 03 minutes 40 seconds and proceed in a Southerly direction for a distance of 279.44 feet; thence turn an angle to the right of 91 degrees, 56 minutes, 20 seconds and proceed in a Westerly direction for a distance of 311.77 feet to the Southeast corner of Lot 1, Silver Spur Estates, First Addition (Map Book 29, Page 92, Bessemer Division); thence turn an angle to the right of 88 degrees, 03 minutes, 40 seconds and proceed in a Northerly direction along the East Line of said Lot 1 for a distance of 279.44 feet to the Point of Beginning.

Melton Road and Silver Spur Lane properties

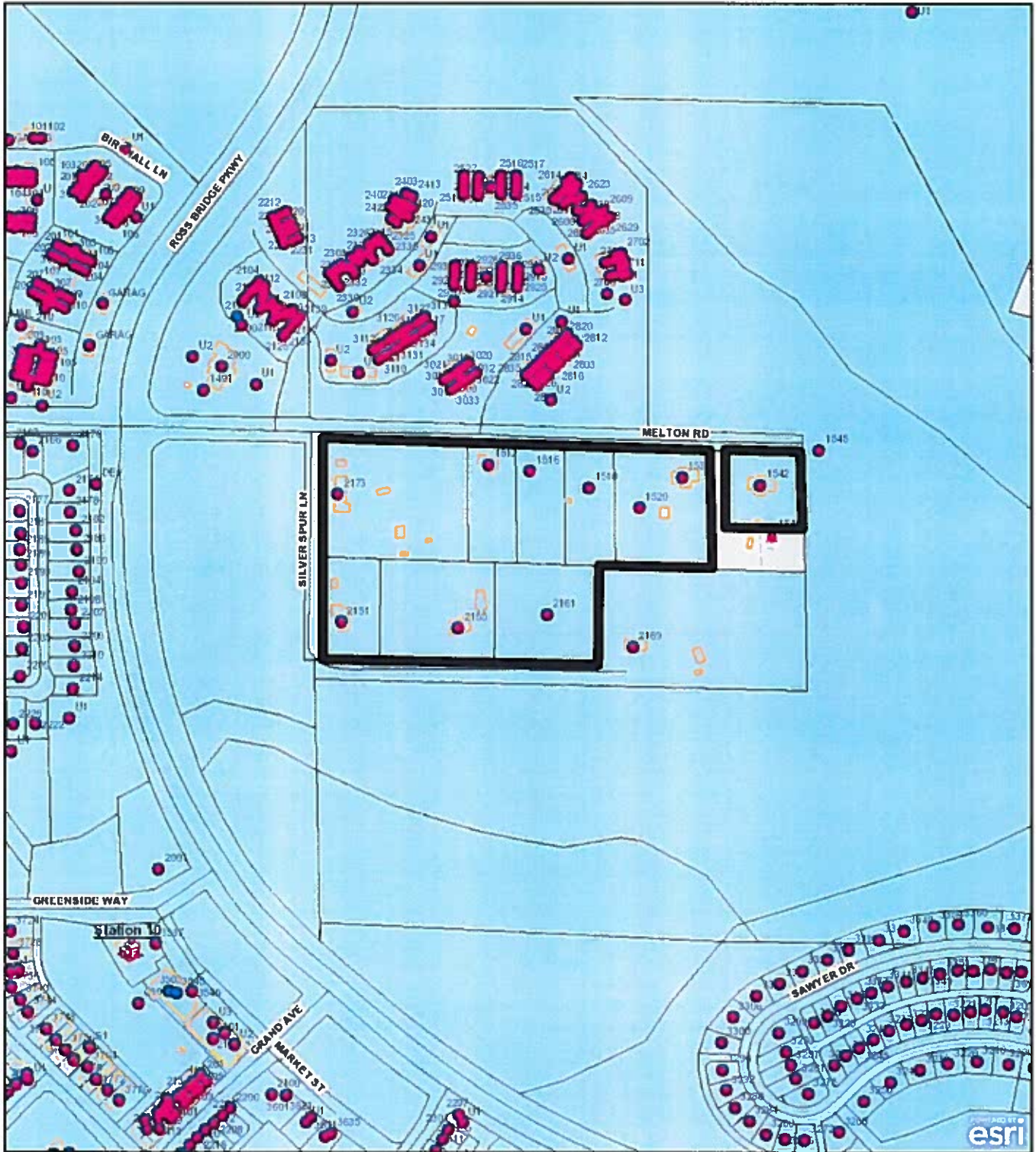

451 ft
Scale Per Inch



This City of Hoover Geographic Information System (GIS) map is used for reference purposes only. The City of Hoover does not guarantee accuracy of the material contained herein and is not responsible for misuse or

Powered by
VANTAGEPOINTS