

ORDINANCE NO. 19-2420

An ordinance to alter, rearrange and extend the corporate limits of the City of Hoover, Alabama, so as to embrace and include within the corporate limits of said City all territory now within such corporate limits and also certain other territory contiguous to said City.

WHEREAS, petitions signed by Juan C. Partillo and Rose Valle; and Susan W. Falls, Executor of Estate of Charles W. Wilson requesting that certain territory described therein be annexed to the City of Hoover, and

WHEREAS, there is attached to the said petitions a map of said territory showing its relationship to the corporate limits of the City; and

WHEREAS, this Council has determined and found that the matters set forth and alleged in the said petitions are true and that it is in the public interest that said properties be annexed into the City of Hoover;

NOW, THEREFORE, be it ordained by the Council of the City of Hoover as follows:

SECTION 1: That said Council hereby assents to the annexation of said territory to the City of Hoover, Alabama, and the corporate limits of the City of Hoover are hereby extended and rearranged pursuant to the provisions of Chapter 42, Article 2, Code of Alabama, 1975 (Sections 11-42-20 through 11-42-23, as amended) so as to embrace and include said territory, in addition to the territory already within its present corporate limits, within the corporate area of said City, which said territory is not within the corporate limits or municipal boundaries of another municipality and does not lie at any point more than one-half the distance between the present corporate limits or municipal boundaries of another municipality and does not lie at any point more than one-half the distance between the present corporate limits and the corporate limits of any other municipality. Said properties are described in **Exhibit "A"** attached hereto and made a part hereof.

SECTION 2: The City Clerk shall file a certified copy of this ordinance containing an accurate description of said annexed territory with the Probate Judge of Jefferson County, Alabama, and also cause a copy of this ordinance to be published as required by state law.

ADOPTED this the 4th day of February, 2019.

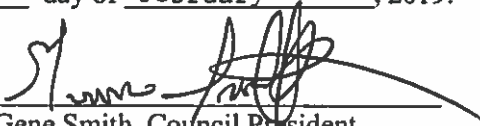

Gene Smith, Council President

APPROVED BY:



Frank V. Brocato, Mayor

ATTESTED:



Margie Handley, City Clerk

EXHIBIT "A"

3269 Monte D'Oro Drive – Tax Parcel ID #39-1-4-004-014.000

Lot 14, Block 2, According the Survey of Monte D'Oro, Second Sector, as recorded in Map Book 73, Page 16, in the Office of the Judge of Probate in Jefferson County, Alabama.

3236 Pinehurst Drive – Tax Parcel ID #39-11-4-007-012.000

Lot 7, Block 5, According to the Survey of Green Valley Fairways Fifth Sector, as recorded in Map Book 1014, Page 26 in the office of the Judge of Probate in Jefferson County, Alabama

3269 Monte D'Oro Drive



204 ft
Scale Per Inch



This City of Hoover Geographic Information System (GIS) map is used for reference purposes only. The City of Hoover does not guarantee accuracy of the material contained herein and is not responsible for misuse or

Powered by
VANTAGEPOINTS

3236 Pinehurst Drive

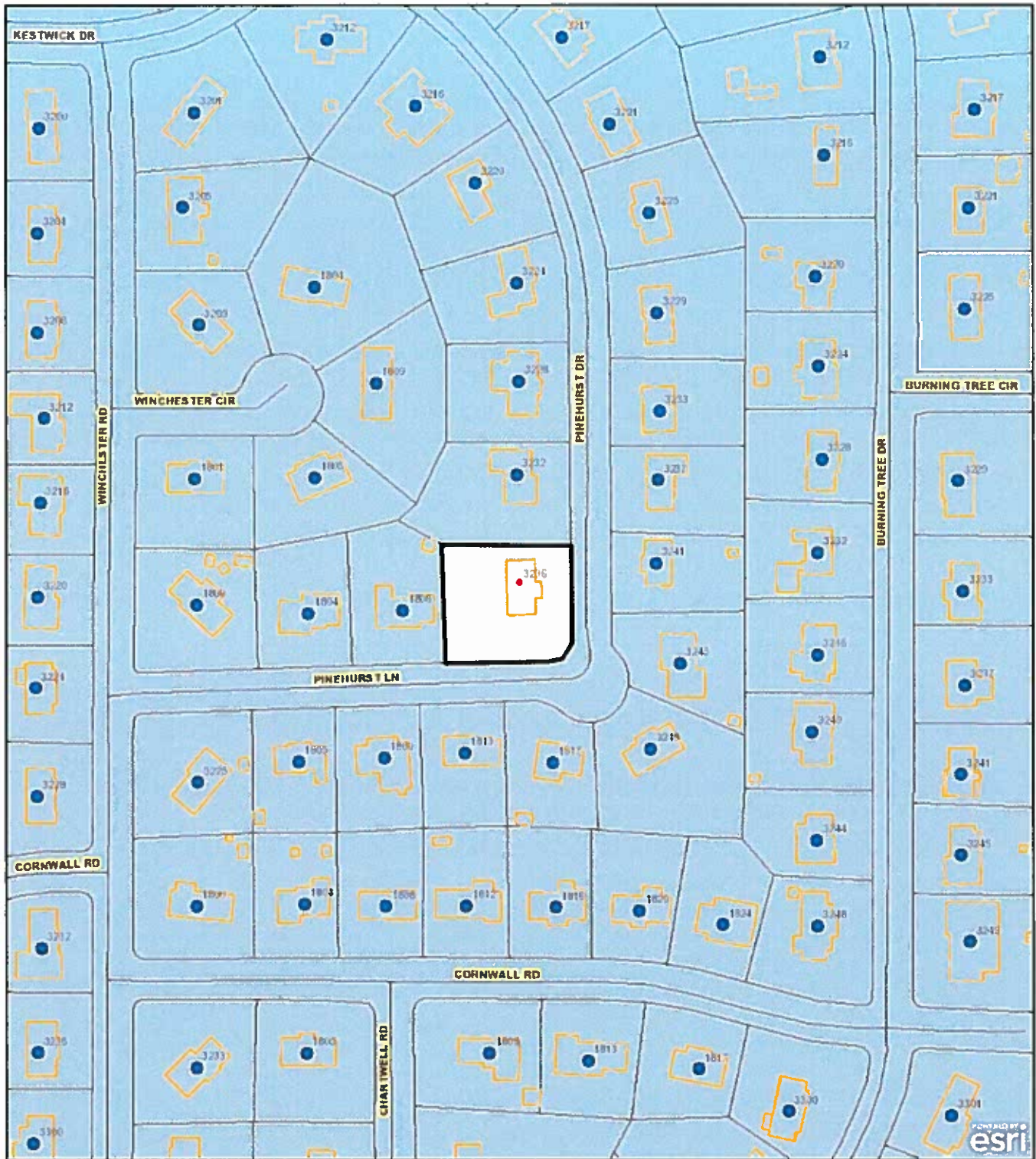

204 ft
Scale Per Inch



This City of Hoover Geographic Information System (GIS) map is used for reference purposes only. The City of Hoover does not guarantee accuracy of the material contained herein and is not responsible for misuse or

Powered by
VANTAGEPOINTS